

**PROJECT:-**

**PROPOSED G+III STORIED RESIDENTIAL BUILDING PLAN U/S 393A, OF K.M.C. ACT 1980 AND K.M.C. BUILDING RULE 2009 AT K.M.C. PREMISES NO - 77, BENI BANERJEE AVENUE IN WARD NO - 092, BOROUGH - X, P.S. - GARFA, KOLKATA - 700031, DIST. - 24 PARGANAS (SOUTH).**

**APPLICANT :-**

SRI SUBRATA BOSE & SRI JAGONNATH HALDER  
PARTNERS OF "AAMAR BARI"  
CONSTITUTED ATTORNEY OF  
SRI SWAPAN KUMAR BANERJEE, SRI AMITAVA BANERJEE  
SMT BAISHAKHI BHOWMICK, SMT TRIPTI BANERJEE  
SRI ARINDAM BANERJEE , SMT ANINDITA BHATTACHARYYA

LATITUTED : 22° 30' 29.06" N  
LONGITUTE : 88° 22' 19.90" E

LATITUTE & LONGITUTE HAS BEEN MEASURED NEAR THE CENTER OF THE PLOT

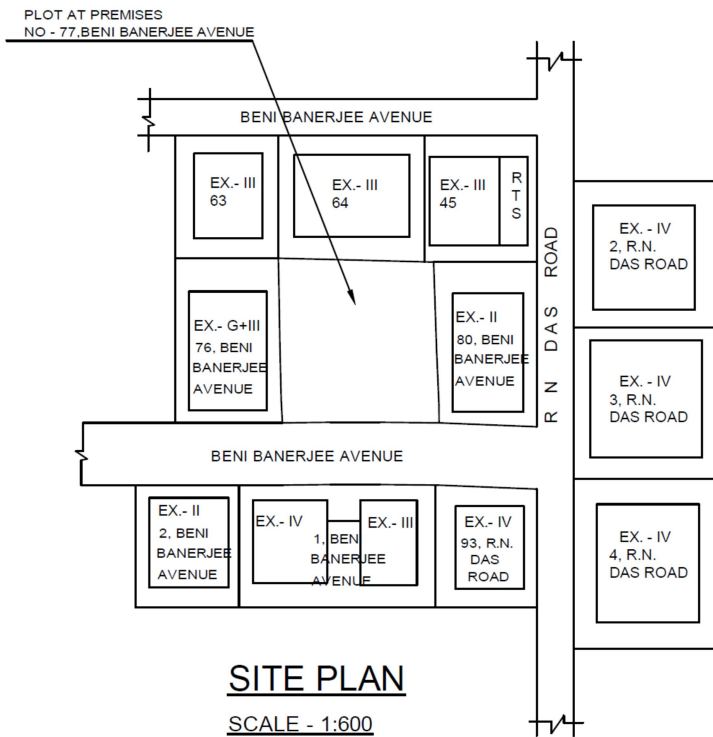

**AAMAR BARI**

Partner

Partner